

Sight Flow Indicators (straight line)

with *butt weld ends* (S)

NORIS

Bauform 112-S

Application:

Sight Flow Indicators are used for optical control and the observation of filling and current in pipelines. Without rest fluid in the body in horizontal installation.

Operating conditions:

Working pressure : 16 bar
Working temperature: 150°C or 280°C

Without rest fluid
in the body

Installation:

Optional

Options:

Flanges in DIN or ANSI
Body in steel
Extra length
Light-fitting

Materials:

Body	WN 1.4571 or 1.4404
Covers	Stainless steel
Screws	A4-70
Glass	Borosilicate glass acc. to DIN 7080 Soda lime glass acc. to DIN 8902
Gasket	Graphite (or other materials)

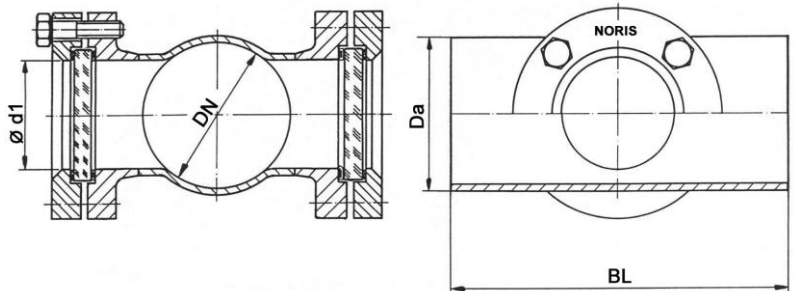

Ordering example:

Sight flow indicators Bauform 112-S
with butt weld ends
Body: WN 1.4571; Borosilicate glass 16 bar
DN 100 / Ø 114,3



Dimensions:

DN / Da	BL	ø d ₁	Glass ø d x s
25 / 33,7	160	23	45 x 10
40 / 48,3	200	39	63 x 10
50 / 60,3	230	44	63 x 10
80 / 88,9	310	64	80 x 12
100 / 114,3	350	80	100 x 15
125 / 139,7	400	80	100 x 15
150 / 168,3	480	100	125 x 20
200 / 219,1	600	125	150 x 25
250 / 273,0	730	150	175 x 25
300 / 323,9	850	150	175 x 25
350 / 355,6	980	150	175 x 25
400 / 406,4	1100	150	175 x 25

Modification reserved

NORIS ARMATUREN Burkenstein GmbH & Co. KG

Puscherstrasse 3
D-90411 Nürnberg

Telefon: +49 (0) 911 / 52 150 63
Telefax: +49 (0) 911 / 52 24 40

Internet: Noris-Armaturen.de
E-Mail: Noris@Noris-Armaturen.de