

Hydraulic Clamp Nut

Oil coupling system

NORIS

Series N30

Features of series

**Axial connected
oil pump**
**Medium remains into
the pump system**



The pressure is based by the connection with the oil pump.
The internal medium will flow into the circular groove and raise the ring piston.
Pressure rate is shown precisely at the pressure gauge.
Relieve the system results in pressure decrease inside the connected pump.
After relieve you have to turn the nut to the opposite direction .
The Medium flows back to the oil pump.

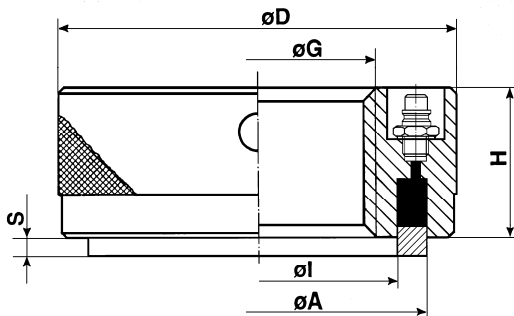

Clamping range
4 mm
6 mm
10 mm

Thread $\varnothing G_{max.}$	Ring piston		Outer Diameter $\varnothing D$	Height H	Clamping Force in kN Pump with max.working pressure		Part No Clamping range S
	$\varnothing A$	$\varnothing I$			400 bar	700 bar	
							4 mm
160	200	180	250	70	240	410	130.04.160
210	272	240	305	75	510	900	130.04.210
280	350	310	380	70	830	1450	130.04.280
							6 mm
210	254	235	300	75	290	510	130.06.210
340	400	370	450	80	720	1270	130.06.340
							10 mm
180	240	215	270	80	360	620	130.10.180
230	280	260	320	85	340	590	130.10.230

Against corrosion our hydraulic clamp nuts are protected with a brown finish.
The standard sealing systems are suitable for temperatures up to 80°.
The ring piston is locked against drop out.

Special design (for example Material - Aluminium hartcoatiert) on request

NORIS

ARMATUREN BURKENSTEIN GMBH & CO. KG
- ABTEILUNG SPANNELEMENTE -

D-90411 Nürnberg
Puscherstraße 3

Telefon: + 49 (0) 911/ 52 15 06 3
Telefax: + 49 (0) 911/ 52 24 40

E-Mail: noris@noris-armaturen.de
Internet: www.noris-armaturen.de