

# Hydraulic Clamp Nut

## Piston system

# NORIS

## Series N10.04-DA

### Features of series with - DA

**Pressure indicator**

**Axial operating  
with Allen key**

**Medium remains into the system**



The actuator screws has to be turned into the body by using the enclosed Allen key.  
The internal medium will flow into the circular groove and raise the ring piston.  
With less manual force you create a big hydraulic clamping force.  
For to relieve the clamp nut put the actuator screws to the start position  
and move the nut to the opposite direction.  
The medium remains into the system.

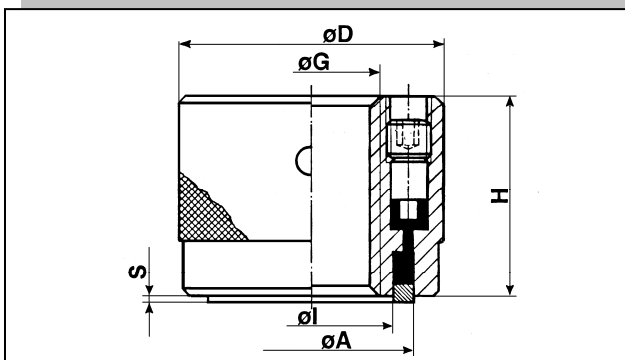

**Clamping range 4 mm**

Thread $\sigma G_{max.}$	Ring piston		Outer Diameter $\sigma D$	Height $H$	Clamping force (achieved by hand) in kN	Part No Clamping range S 4 mm
	$\sigma A$	$\sigma I$				
18	34	26	54	60	40	110.04.020-DA
24	40	32	60	67	40	110.04.024-DA
30	52	40	72	75	80	110.04.030-DA
36	55	44	78	77	80	110.04.036-DA
52	72	60	98	80	90	110.04.052-DA
68	92	82	120	80	90	110.04.068-DA
80	100	88	130	85	80	110.04.080-DA
100	125	110	155	95	100	110.04.100-DA

Against corrosion our hydraulic clamp nuts are protected with a brown finish.  
The standard sealing systems are suitable for temperatures up to 80°.  
The ring piston is locked against drop out.

Special design of hydraulic clamp nuts on request

# NORIS

## ARMATUREN BURKENSTEIN GMBH & CO. KG

– ABTEILUNG SPANNELEMENTE –

D-90411 Nürnberg  
Puscherstraße 3

Telefon: + 49 (0) 911/ 52 15 06 3  
Telefax: + 49 (0) 911/ 52 24 40

E-Mail: [noris@noris-armaturen.de](mailto:noris@noris-armaturen.de)  
Internet: [www.noris-armaturen.de](http://www.noris-armaturen.de)