

# Manhole cover with sight glass

to be mounted similar to DIN 28120

( Hand hole, Inspection flange )

# NORIS

## Bauform 1205

### Application:

By using the integrated sight glass you save a further hole in the vessel.

The fittings shows two functions: a) Compression res. Sight glass  
b) Man hole service opening etc.

### Operating conditions:

Working pressure: by agreement

Working temperature: 150°C or 280°C

### Options:

Base flanges to be welded

Safety seal-system acc. to DIN 28121

Wiper

Spray washer

Sight glass light fittings

### Materials:

Base and cover flanges	Steel or Stainless steel
------------------------	--------------------------

Glass	Borosilicate glass DIN 7080 Soda-lime-Glas DIN 8902
-------	--

### Dimensions:

DN 150 to DN 800

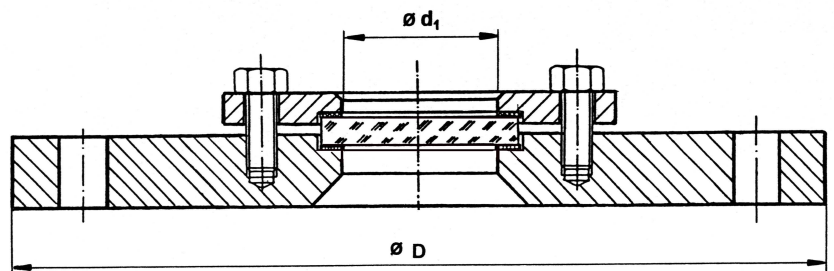

Modifications reserved

# NORIS ARMATUREN Burkenstein GmbH & Co. KG

Puscherstrasse 3  
D-90411 Nürnberg

Telefon: +49 (0) 911 / 52 150 63  
Telefax: +49 (0) 911 / 52 24 40

Internet: [Noris-Armaturen.de](http://Noris-Armaturen.de)  
E-Mail: [Noris@Noris-Armaturen.de](mailto:Noris@Noris-Armaturen.de)